

Valves of stainless steel

# Reject Valves

SAQP/G

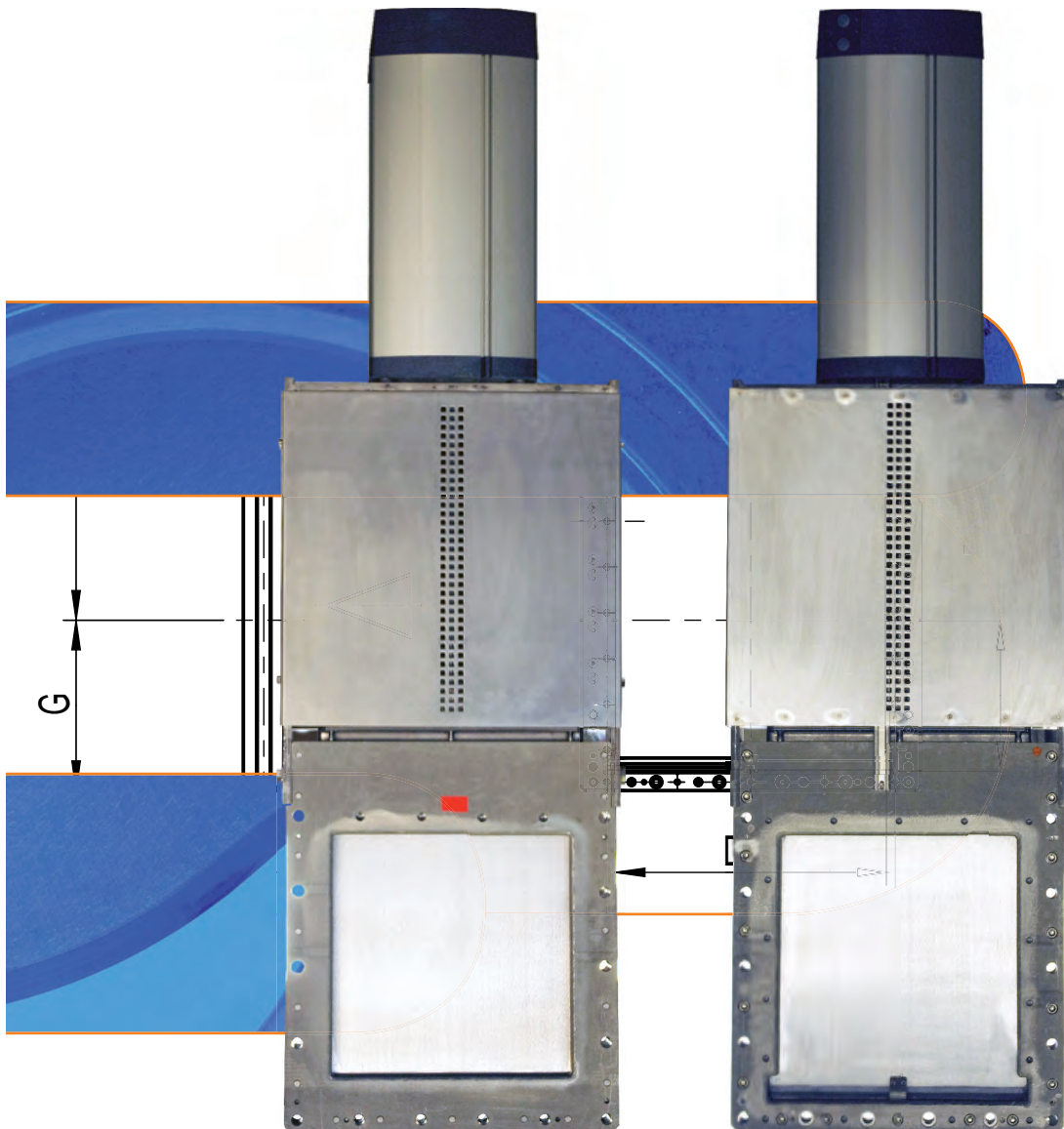

MARTIN LOHSE GmbH  
 Unteres Paradies 63 · D-89522 Heidenheim  
 Postfach 1565 · D-89505 Heidenheim  
 phone +49(0)7321 / 755-42 · fax +49(0)7321 / 755-97  
 server.ab@lohse-gmbh.de  
 www.lohse-gmbh.de

## Applications

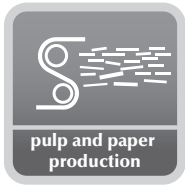

### General usage

- media with reject fraction
- coarse-grained media (granular material)
- fine-grained media (powder)
- temperature range -10 to 80° C

### Locations

- pulper drain unit
- discharging device
- dumping and emptying devices

## Description

- Valves of stainless steel with square inlet and outlet.
- Square design.
- Extended outlet space for unhindered discharge of reject.
- Valve plate in stainless steel, prepared for mounting the switch button of end position control unit.
- Valve plate guide by slide cups and slide borders guarantees maximum slip.
- Replaceable sliding components.

## Watertight

Leak test according to DIN EN 12266-02:2012-04  
Table A5, test medium liquid, leakage rate A

## Materials

- housing 1.4571
- valve plate 1.4571
- sealings EPDM
- slide borders RCH 1000  
(ultra-high molecular weight low pressure polyethylene)
- bracket St 37
- max. operating pressure 4 bar
- max. operating temperature 80° C

Flange bores for LOHSE SAQ-valves with metric thread according to LOHSE standard

Inlet side

Outlet side

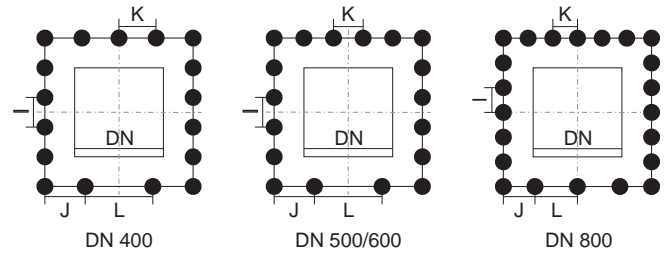
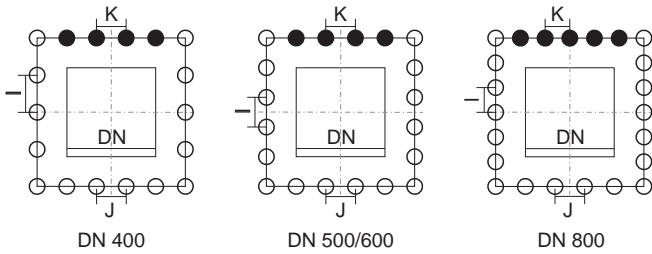

DN [mm]	Z	M	T [mm]	Z1	Z2	l [mm]	J [mm]	K [mm]
400	18	M16	21	4	14	125	103	103
500	20	M20	16	4	16	113	123	123
600	20	M20	16	4	16	132	145	145
800	23	M20	23	5	18	153	186	155

DN [mm]	Z	M	T [mm]	Z1	l [mm]	J [mm]	K [mm]	L [mm]
400	17	M12	15	17	99	130	110	180
500	18	M12	15	18	122	150	109	246
600	18	M12	17	18	150	187	131	290
800	23	M12	20	23	135	208	170	217

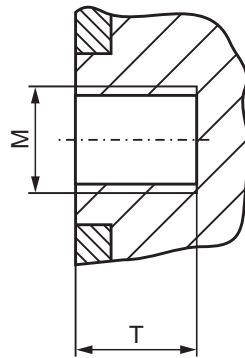

- Z = total number of holes
- Z1 = number of joint-holes
- Z2 = number of through-going bores
- T = usable depth of thread

Reject valves of stainless steel  
square inlet and outlet  
pneumatic cylinder and protection guard

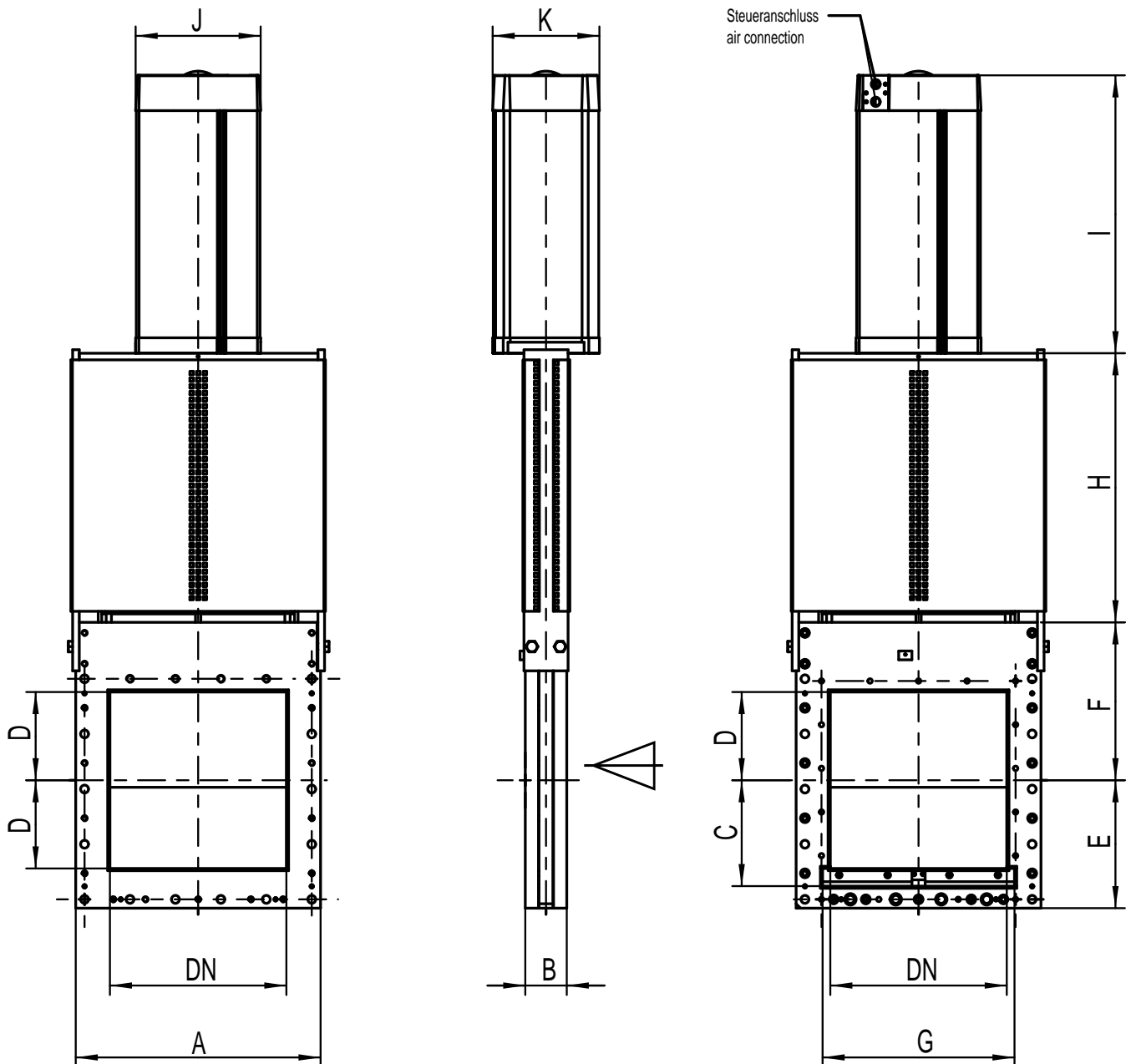

DN	PS [bar]	A	B	C	D	E	F	G	H	I	J	K	cyl. Ø	air connection	control pressure
400	4	555	94	240	200	290	358	435	610	630	283	242	230	G 1/2"	6

Dimensions in mm, flange bores to on request; air connection acc. VDI/VDE 3845 (NAMUR).  
Further sizes on request.

Reject valves of stainless steel  
square inlet and outlet  
pneumatic cylinder and protection guard

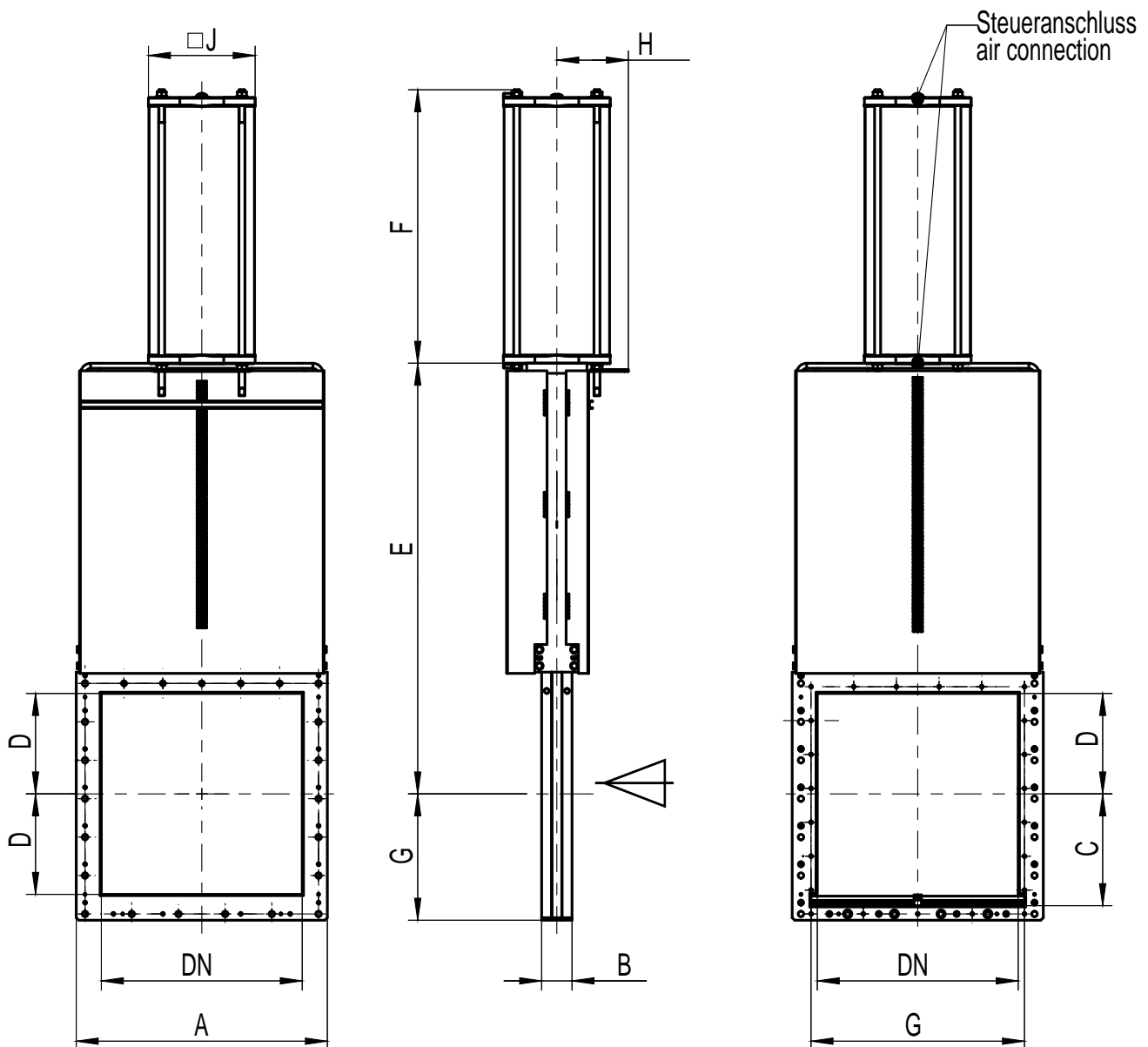

DN	PS [bar]	A	B	C	D	E	F	G	H	J	cyl. Ø	air connection	control pressure
500	2,5	655	96	290	250	1179	721	350	200	318	300	G 1/2"	6
600	2	765	95	340	300	1348	823	400	200	318	300	G 1/2"	6
800	1,5	1000	121	445	400	1715	1089	503	285	425	400	G 3/4"	6

Dimensions in mm, flange bores to on request.  
Further sizes on request.

## Germany + Switzerland

**MARTIN LOHSE GmbH**  
Postfach 1565  
89505 Heidenheim  
Phone: +49 (0) 73 21 / 7 55-0  
Fax: +49 (0) 73 21 / 7 55-99  
server.ab@lohse-gmbh.de  
www.lohse-gmbh.de

## Australia, New Zealand, Indonesia, Singapore, Malaysia

**P.T. VOITH PAPER**  
Jl. Permata V Lot EE - 1  
Kawasan Industri KIIC  
Karawang 41361, INDONESIA  
Phone : +62 267 419 719  
Fax : +62 267 419 717

## Austria (pulp + paper industry, wastewater + wastewater treatment plants) + CZ, SK, SLO, SRB, HR, H

**Peter Reiter**  
Handel Mazzetti-Str. 85  
3100 St. Pölten  
Phone: +43 (0) 27 42 / 7 73 66  
Fax: +43 (0) 27 42 / 7 73 66  
fa.reiter@aon.at

## Austria

**Klinger Gebetsroither GmbH & Co KG**  
Am Kanal 8-10  
2352 Gumpoldskirchen  
Phone: +43 2252 60 71 00 3029  
Fax: +43 2252 60 71 00 3010  
gerhard.praxmarer@gebetsroither.at  
www.gebetsroither.at

## Belgium

**Hanwel Belgium N.V.**  
Winninglaan 15  
9140 Temse  
Phone: +32 (0) 3 / 7 11 03 53  
Fax: + 32 (0) 3 / 7 11 05 79  
info@hanwel.be  
www.hanwel.be

## Chile

**INTERTECH**  
Prat 116, Of 31  
Curicó, Chile  
phone +56.075.322033  
www.inter-tech.cl  
n.flores@inter-tech.cl

## People's Rep. Of China

**Shanghai Fier Mechanical Co. LTD**  
Room B4, 15/F HuaFu Bldg.  
No. 585 LongHua xi Rd.  
ShangHai, China 200232  
Phone: +86-21-54591038  
Fax: +86-21-54240616  
MP: 13611665381  
shfier@163.com  
www.fier.com.cn

## Denmark

**Uni-Valve A/S**  
Sydvestvej 138 – 140  
2600 Glostrup  
Phone: +45 (0) 43 43 82 00  
Fax: +45 (0) 43 43 74 75  
mail@uni-valve.com  
www.uni-valve.com

## Finland

**Klinger Finland Oy Aseko**  
Tinankuja 3  
02430 Masala  
Phone: +358 (0) 10 400 10 12  
Fax: +358 (0) 10 400 12 00  
info@aseko.fi  
www.aseko.fi

## France, MA, TN, DZ T.N.P.

30 avenue Galliéni  
94100 Saint-Maur  
Phone: +33 (0) 1 / 55 97 11-11  
Fax: +33 (0) 1 / 48 83 52 07  
contact@tnp.fr  
www.tnp.fr

## Great Britain

**Voith Turbo Ltd.**  
6 Beddington Farm Road  
Croydon, Surrey CRO, 4XB  
Phone: +44 (0) 2 08 / 6 67 30 13  
Fax: +44 (0) 2 08 / 6 67 04 03  
matthew.healy@voith.com

## Greece

**Niko Mikopoulos, BSc.**  
Metron Str. 28  
17123 Nea Smyrni-Athens  
Phone: +30 6 98 305 10 70  
n.mikopoulos@nm-bc.com

## India

**Antrieb Technik Private Limited**  
59 (old 359) Sidco Industrial Estate  
Ambattur  
Chennai-600 098  
Tamilnadu / INDIA  
Phone: +91 (44) 262 – 58303  
Fax: +91 (44) 2819 – 3718  
antrieb.technik@gmail.com

## Israel

**P.B.A Wiesner Agencies Ltd.**  
P. O. Box 4622  
Petach-Tikva 49277  
Phone: +972 (0) 3 / 9 05 21 11  
Fax: +972 (0) 3 / 9 05 21 10  
ofra@pba.co.il

## Italy

**Techno Paper S.R.L.**  
Viale Certosa 269  
20151 Milano (MI)  
Phone: +39 (0) 02 78627750  
Fax: +39 (0) 02 45471638  
info@techno-paper.com  
www.techno-paper.com

## Japan

**Voith IHI Paper Technology Co.Ltd.**  
River City M-SQUARE 7F  
2-1-6 Tsukuda, Chuo-ku  
1040051 Tokyo  
Phone: +81 3 6221 3108  
Fax: +81 3 6221 3126

## Korea

**C.S-Automation Co., Ltd. (Customer Satisfaction Automation)**  
#804 Sejung Technovalley  
279-5 Songjeong-Dong  
Heungdeok-Gu  
Cheongju-Si  
South Korea. 361-290  
Phone: +82 43 276 1332  
Fax: +82 43 278 1332  
changseol@korea.com

## Netherlands

**Hanwel B. V.**  
Jan Tinbergenstraat 209  
7559 SP Hengelo  
The Netherlands  
Phone: +31 74-2650000  
Fax: +31 74-2650001  
verkoop@hanwel.com  
www.hanwel.com

## Norway

**KSB Norge AS**  
Haugenveien 29  
1400 SKI  
Phone: +47 96 900 900  
firmapost@ksb.com  
www.ksb.com/ksb-no

## Philippines

**R. Dan and Co., Inc.**  
20 Alfonso St.  
Rosario  
Pasig City 1609  
Phone: +632 – 6558796  
Fax: +632 – 6562089  
ester.poe@robertdan.com.ph  
www.robertdan.com.ph

## Poland

**Waldemar Kulicki**  
ul. Heweliusza 37/4  
87-148 Papowo Toruńskie  
Phone: +48 56 / 6783399  
Fax: +48 56/ 6783880  
waldemar-kulicki@wp.pl  
www.wkulicki.eu

## Rep. of South Africa

**Voith Turbo (Pty) Ltd**  
P.O. Box 13171  
Witfield, 1467  
Gauteng, SOUTH AFRICA  
Phone: +27 11 418 4000  
Fax: +27 11 418 4080  
info.vtza@voith.com  
www.rsa.voithturbo.com

## Spain, Portugal

**CELPAP EQUIPOS, S.L.**  
C/Amposta, 14-18  
08174 Sant Cugat del Vallés  
(Barcelona)  
Phone +34 93 415 18 75  
celpap@celpap.com  
www.celpap.com

## Sweden

**PA-Ventiler AB**  
Sagbäcksvägen 3B  
43736 Lindome  
Phone: +46 (0) 31 / 99 25 00  
Fax: +46 (0) 31 / 99 25 03  
info@paventiler.se  
www.paventiler.se

## Taiwan

**E-Chen Engineering Co., Ltd.**  
3F-3, No. 151, Sec. 4,  
Hsin-Yi Road,  
Taipei, Taiwan, R.O.C.  
Phone: +886 (0) 22 / 7056185  
Fax: +886 (0) 22 / 7 04 59 67  
echen123@ms15.hinet.net

## Thailand

**Weston Myer Ltd.**  
8 Soi Seri-Thai 58  
Seri-Thai Road  
10510 Minburi Bangkok  
Phone: +66 (0) 2 / 3 74 58 69  
Fax: +66 (0) 2 / 3 75 – 11 79  
comm1@westonmyer.com

## Turkey

**Sanrep Kağıt San. ve Tic. Ltd. Şti.**  
Altıyol, Kuşdili Caddesi No:19/7  
H.Fazlıoğlu İş Merkezi  
34714 Kadıköy – İSTANBUL  
Phone: +90 216 345 40 48  
Fax: +90 216 330 73 12  
sanrep@sanrep.com  
www.sanrep.com

## USA, Canada, Mexico

**Voith Paper Inc.**  
2200 N. Roemer Rd.  
Appleton, WI 54912-2237  
Phone: +1 (0) 920 – 358 – 2486  
Fax: +1 (0) 920 – 221 – 8904  
igor.figureira@voith.com